

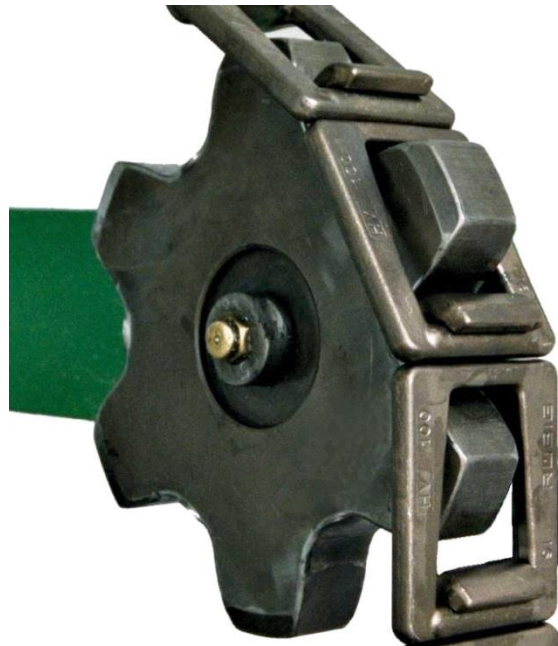

## RÜBIG SPROCKETS



Sprockets, which fit to the several RÜBIG chains, ensure by their improved tooth design:

- reliable power transmission and ease of motion
- less wear and tear
- long lifecycles

following versions are available:

- **steel wheel - blanks** (discs with ready tooth contour):  
are universally usable and cover most applications.
- **readily machined sprockets**  
kind of steel and design of the hub according to the customers requirements,  
optionally with feather key groove, thread, bearing, hardened contour, etc.

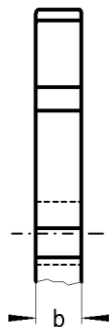
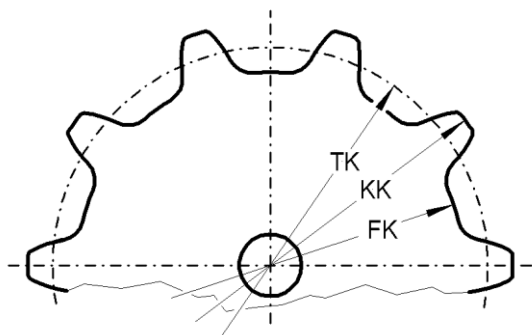

sprockets for the series „Classik“ and series „C“						
size	chain	teeth	TK	FK	KK	b
29,3/6	T29,3	6	ø 58,6	ø 43,6	ø 76,3	15
29,3/7	T29,3	7	ø 67,5	ø 52,5	ø 82,5	15
29,3/8	T29,3	8	ø 76,6	ø 61,6	ø 91,6	15
29,3/9	T29,3	9	ø 85,7	ø 70,7	ø 100,7	15
35/6	T35	6	ø 70,7	ø 55,0	ø 85,0	15
35/7	T35	7	ø 80,7	ø 65,7	ø 95,7	15
35/8	T35	8	ø 91,5	ø 76,5	ø 106,5	15
35/9	T35	9	ø 102,3	ø 87,3	ø 117,3	15
39/6	T39	6	ø 78,0	ø 62,0	ø 94,0	18
39/7	T39	7	ø 89,9	ø 73,9	ø 105,9	18
39/8	T39	8	ø 101,9	ø 85,9	ø 117,9	18
39/9	T39	9	ø 114,0	ø 98,0	ø 130,3	18
41,3/6	T41,3	6	ø 82,6	ø 65,1	ø 98,6	18
41,3/7	T41,3	7	ø 95,2	ø 77,7	ø 111,2	18
41,3/8	T41,3	8	ø 107,9	ø 90,5	ø 123,9	18
41,3/9	T41,3	9	ø 120,8	ø 103,3	ø 136,8	18
44/6	T44	6	ø 88,0	ø 67,4	ø 106,0	20
44/7	T44	7	ø 101,4	ø 80,8	ø 119,4	20
44/8	T44	8	ø 115,0	ø 94,2	ø 133,0	20
44/9	T44	9	ø 128,6	ø 107,8	ø 146,6	20

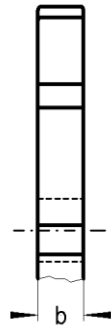
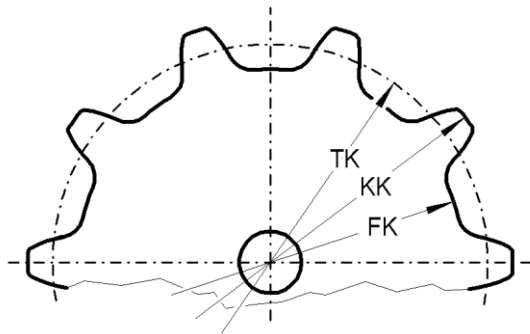

sprockets for the series „Classik“ and series „C“						
size	chain	teeth	TK	FK	KK	b
49/6	T49	6	∅ 98,0	∅ 82,0	∅ 114,0	18
49/7	T49	7	∅ 112,9	∅ 96,9	∅ 128,9	18
49/8	T49	8	∅ 128,0	∅ 112,0	∅ 144,0	18
49/9	T49	9	∅ 143,3	∅ 127,3	∅ 159,3	18
59S/6	T59S	6	∅ 118,0	∅ 102,0	∅ 134,0	18
59S/7	T59S	7	∅ 136,0	∅ 120,0	∅ 152,0	18
59S/8	T59S	8	∅ 154,2	∅ 138,2	∅ 170,2	18
59S/9	T59S	9	∅ 172,5	∅ 156,5	∅ 188,5	18
59/6	T59	6	∅ 118,0	∅ 98,3	∅ 136,0	22
59/7	T59	7	∅ 136,0	∅ 116,3	∅ 154,0	22
59/8	T59	8	∅ 154,2	∅ 134,5	∅ 172,2	22
59/9	T59	9	∅ 172,5	∅ 152,8	∅ 190,5	22
60,6/6	C6	6	∅ 121,2	∅ 93,0	∅ 145,2	25
60,6/7	C6	7	∅ 139,7	∅ 111,3	∅ 163,7	25
60,6/8	C6	8	∅ 158,4	∅ 129,8	∅ 182,4	25
60,6/9	C6	9	∅ 177,2	∅ 148,5	∅ 201,2	25
67/6	T67(B) / C7	6	∅ 134,2	∅ 108,0	∅ 158,2	25
67/7	T67(B) / C7	7	∅ 154,6	∅ 128,2	∅ 178,6	25
67/8	T67(B) / C7	8	∅ 175,3	∅ 148,7	∅ 199,3	25
67/9	T67(B) / C7	9	∅ 196,2	∅ 169,6	∅ 220,2	25

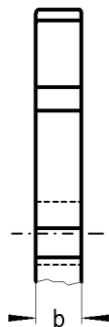
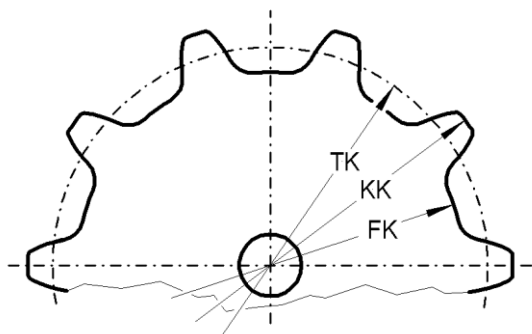

sprockets for the series „Classik“ and series „C“						
size	chain	teeth	TK	FK	KK	b
78,5/5	T78,5 / C8	5	∅ 133,6	∅ 97,0	∅ 163,6	30
78,5/6	T78,5 / C8	6	∅ 157,0	∅ 124,0	∅ 187,0	30
78,5/7	T78,5 / C8	7	∅ 180,9	∅ 147,7	∅ 210,9	30
78,5/8	T78,5 / C8	8	∅ 205,1	∅ 171,7	∅ 235,1	30
78,5/9	T78,5 / C8	9	∅ 229,5	∅ 196,0	∅ 259,5	30
100/5	T100 / C10	5	∅ 170,1	∅ 131,7	∅ 205,1	30
100/6	T100 / C10	6	∅ 200,0	∅ 162,2	∅ 235,0	35
100/7	T100 / C10	7	∅ 230,5	∅ 192,2	∅ 265,5	35
100/8	T100 / C10	8	∅ 261,3	∅ 223,3	∅ 296,3	35
100/9	T100 / C10	9	∅ 292,4	∅ 254,3	∅ 327,4	35
125/5	T125 / C12	5	∅ 212,7,	∅ 168,7	∅ 257,7	30
125/6	T125 / C12	6	∅ 250,0	∅ 206,0	∅ 295,0	35
125/7	T125 / C12	7	∅ 288,1	∅ 244,1	∅ 333,1	35
125/8	T125 / C12	8	∅ 326,6	∅ 282,6	∅ 371,6	35
125/9	T125 / C12	9	∅ 365,5	∅ 321,5	∅ 410,5	35

more sprocket sizes up to ∅2000 mm (one-piece) or larger (only in segments) available on request.

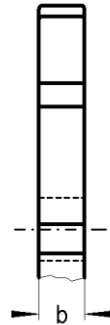
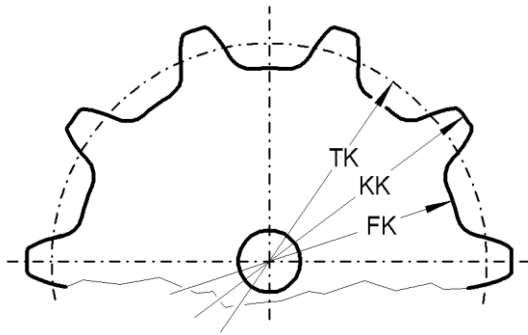

sprockets for the series „V”						
size	chain	teeth	TK	FK	KK	b
V2010/5	V2010	5	∅ 170,1	∅ 150,1	∅ 190,1	32
V2010/5,5	V2010	5,5	∅ 185,0	∅ 165,0	∅ 205,0	32
V2010/6	V2010	6	∅ 200,0	∅ 180,0	∅ 220,0	32
V2010/6,5	V2010	6,5	∅ 215,2	∅ 195,2	∅ 235,2	32
V2010/7	V2010	7	∅ 230,5	∅ 210,5	∅ 250,5	32
V2010/7,5	V2010	7,5	∅ 245,9	∅ 225,9	∅ 265,9	32
V2010/8	V2010	8	∅ 261,3	∅ 241,3	∅ 281,3	32
V2010/8,5	V2010	8,5	∅ 276,8	∅ 256,8	∅ 296,8	32
V2010/9	V2010	9	∅ 292,4	∅ 272,4	∅ 312,4	32

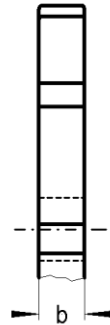
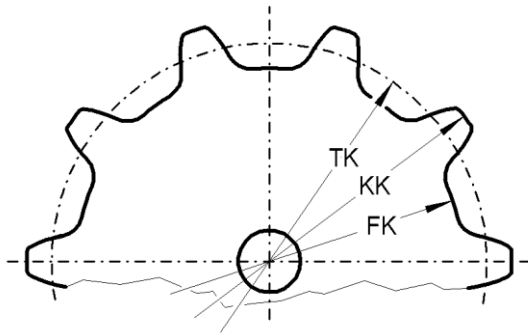

sprockets for the Heavy Duty Drive Chain						
size	chain	teeth	TK	FK	KK	b
50/6	50	6	∅ 100,0	∅ 76,0	∅ 124,0	12
50/7	50	7	∅ 115,2	∅ 91,2	∅ 139,2	12
50/Z8	50	8	∅ 130,7	∅ 106,7	∅ 154,7	12
50/Z9	50	9	∅ 146,2	∅ 122,2	∅ 170,2	12
100xs/5	100 xs	5	∅ 170,1	155,1	185,1	12
100xs/5,5	100 xs	5,5	∅ 185,0	170,0	200,0	12
100xs/6	100 xs	6	∅ 200,0	185,0	215,0	12
100xs/6,5	100 xs	6,5	∅ 215,2	200,2	230,2	12
100xs/7	100 xs	7	∅ 230,5	215,5	245,5	12
100xs/7,5	100 xs	7,5	∅ 245,9	230,9	260,9	12
100xs/8	100 xs	8	∅ 261,3	246,3	276,3	12
100s/5	100 s	5	∅ 170,1	∅ 146,1	∅ 194,1	25
100s/5,5	100 s	5,5	∅ 185,0	∅ 161,0	∅ 209,0	25
100s/6	100 s	6	∅ 200,0	∅ 176,0	∅ 224,0	25
100s/6,5	100 s	6,5	∅ 215,2	∅ 191,2	∅ 239,2	25
100s/7	100 s	7	∅ 230,5	∅ 206,5	∅ 254,5	25
100s/7,5	100 s	7,5	∅ 245,9	∅ 221,9	∅ 269,9	25
100s/8	100 s	8	∅ 261,3	∅ 237,3	∅ 285,3	25