

RÜBIG DIN-LINCHPIN

- drop forged shaft
- 3rd hole for fixing the safety chain
- spring made from spring steel wire
- galvanized and thick film passivated

RÜBIG DIN-Linchpins meet all requirements by DIN 11023. Intermediate and special sizes are designed analogue.

Some sizes are available in stainless steel „V4A“, also. (see RÜBIG INOX-Clip)

RÜBIG DIN-Linchpin

size	order no.	d1 [Inch]	d2 [Inch]	l1 [Inch]	l2 [Inch]	b1 [Inch]	b2 [Inch]	PU (pcs.)	
								big	small
4x27	01382000	3,8 5/32	20 25/32	27 1-1/16	42 1-11/16	11 7/16	29 1-3/16	2000	100
5x32	01472000	4,7 3/16	25 31/32	32 1-1/4	48 1-7/8	11 7/16	34 1-3/8	2000	100
5x42	01472200	4,5 3/16	32 1-1/4	42 1-5/8	63 2-1/4	13,5 9/16	50 1-15/16	1000	100
6x27	01582000	5,8 7/32	20 25/32	27 1-1/16	43 1-11/16	11 7/16	29 1-3/16	2000	100
6x32	01572000	5,7 7/32	25 31/32	32 1-1/4	48 1-7/8	11 7/16	34 1-3/8	2000	100
6x42	01552000	5,5 7/32	32 1-1/4	42 1-5/8	63 2-1/4	13,5 9/16	49 1-15/16	1000	100
6x55	01552200	5,5 7/32	45 1-25/32	55 2-3/16	72 2-13/16	15 9/16	59 2-5/16	500	50
6x62	01552900	5,5 9/32	53 1-1/4	62 1-5/8	83 2-1/4	20 9/16	69 1-15/16	500	50



RÜBIG DIN-Linchpin								PU (pcs.)	
size	order no.	d1 [Inch]	d2 [Inch]	l1 [Inch]	l2 [Inch]	b1 [Inch]	b2 [Inch]	big	small
8x32	01772000	7,5 9/32	25 31/32	32 1-1/4	48 1-7/8	11 7/16	34 1-3/8	1000	100
8x42	01752000	7,5 9/32	32 1-1/4	42 1-5/8	63 2-1/4	13,5 9/16	49 1-15/16	1000	100
8x55	01752000	7,5 9/32	45 1-25/32	55 2-3/16	72 2-13/16	15 9/16	59 2-5/16	500	50
8x62	01752900	7,5 9/32	53 2-3/32	62 2-7/16	83 3-1/4	20 13/16	69 2-5/8	500	50
8x75	01752400	7,5 9/32	60 2-3/8	75 2-15/16	95 3-3/4	21,5 7/8	81 3-1/16	-	-
10x45	01952000	9,5 3/8	32 1-1/4	45 1-3/4	62 2-7/16	15 9/16	49 1-15/16	1000	100
10x55	01952200	9,5 3/8	45 1-25/32	55 2-3/16	72 2-13/16	15 9/16	59 2-5/16	500	50
10x65	01952300	9,5 3/8	53 2-3/32	65 2-9/16	85 3-3/8	21,5 13/16	67 2-5/8	500	50
10x75	01952400	9,5 3/8	60 2-3/8	75 2-15/16	95 3-3/4	21,5 7/8	81 3-1/16	-	-
10x100	01952500	9,5 3/8	80 3-5/32	100 3-15/16	124 4-7/8	25 31/32	100 3-15/16	-	-
10x125	01952600	9,5 3/8	105 4-1/8	125 4-29/32	155 6-3/32	30 1-3/16	132 5-3/16	-	-
12x45-	01112000	10,5 13/32	32 1-1/4	45 1-3/4	62 2-7/16	15 9/16	50 1-15/16	1000	100
12x45+	01122000	11,5 7/16	32 1-1/4	45 1-3/4	62 2-7/16	15 9/16	50 1-15/16	1000	100
12x55+	01122200	11,5 7/16	45 1-25/32	55 2-3/16	72 2-13/16	15 9/16	59 2-5/16	500	50
12x65	01122300	11,5 7/16	53 2-3/32	65 2-9/16	85 3-3/8	21,5 13/16	67 2-5/8	500	50
12x75	01122400	11,5 7/16	60 2-3/8	75 2-15/16	95 3-3/4	21,5 7/8	81 3-1/16	300	30
12x100	01122500	11,5 7/16	80 3-5/32	100 3-15/16	124 4-7/8	25 31/32	100 3-15/16	-	-
17x60	01162000	15,5 5/8	53 1-25/32	60 2-3/8	80 3-5/16	20 13/16	67,5 2-5/16	500	50
17x75	01162200	15,5 5/8	60 2-3/8	75 2-15/16	95 3-3/4	21,5 7/8	81 3-1/16	300	30



Please note:

The largest bolt diameter, can be secured with the linch pins, listed, requires the bolt ends be designed in accordance with the standard. The series of dimensions according to DIN 11023 has been supplemented to suit the size range:

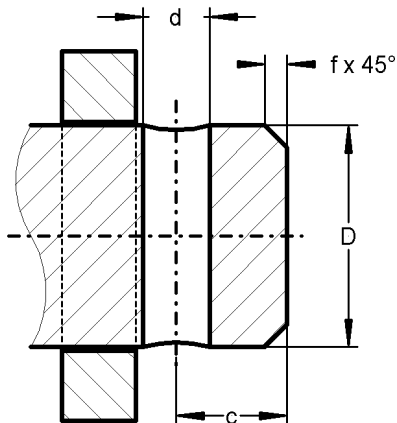

size(s)	D	d	c	f
4x27 / 6x27	20 0,79	4 / 6 0,16 / 0,24	6 0,24	2 0,08
5x32 / 6x32 / 8x32	25 1,0	5 / 6 / 8 0,20 / 0,24 / 0,31	8 0,31	2 0,08
5x42 / 6x42 / 8x42	32 1,25	5 / 6 / 8 0,2 / 0,24 / 0,31	10 0,39	2 0,08
8x62	53 2,09	8 0,31	12 0,47	3 0,12
10x45 / 12x45	32 1,25	10 / 12 0,39 / 0,47	14 / 16 0,55 / 0,63	3 0,12
6x55 / 8x55 / 10x55 / 12x55	45 1,77	6 / 8 / 10 / 12 0,24 / 0,31 / 0,39 / 0,47	12 / 14 / 16 0,47 / 0,55 / 0,63	3 0,12
10x65 / 12x65	53 2,09	10 / 12 0,39 / 0,47	14 / 16 0,55 / 0,63	4 0,16
12x75	60 2,36	12 0,47	17 0,67	5 0,20
10x100 / 12x100	80 3,15	10 / 12 0,39 / 0,47	18 0,71	6 0,24
17x60	45 1,77	17 0,69	21 0,83	6 0,24
17x75	60 2,36	17 0,69	21 0,83	6 0,24